

JCF-3 & JCF-5 Series

Our standard JCF-3 and JCF-5 series are available in 6 bar and 10 bar. The housings are very suitable for use in brackish water, seawater applications and also have high resistance against acids. The housing are designed according to the PED. The position of the inlet and outlet can be changed if another position is preferred. Options: valves, pressure gauges, automatic air release. LFS calculates the chemical, temperature and pressure influences on the housing.

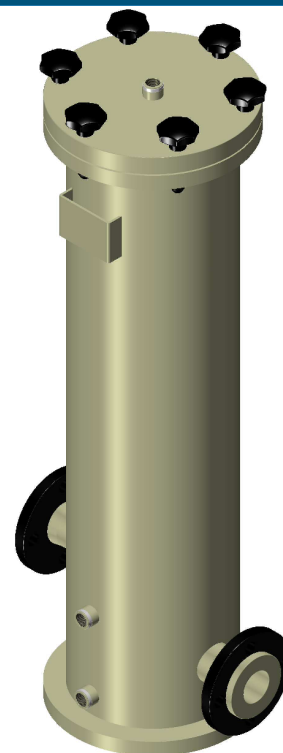

Specifications

Materials	
Housing	Polypropylene (PP)
	Polyethylene (HD-PE)
Bolts	Stainless steel
O-ring	EPDM/FPM
Dimensions	
Diameter JCF-3	225 mm
Diameter JCF-5	250 mm
Cartridge length	10" to 60"
Other	
Inlet/Outlet	DN 25 to 100
	½" to 2"
Drains/vent	½" BSP
Max. temperature	60°C
Max. pressure @ 40° C	6 bar or 10 bar

Ordering code: JCF-575-PP6E-DOE-50F

Type	DN + Connection
JCF = Cartridge	F = Flange
JBF = Bagfilter	FT = Female Thread
JSF = Strainer	MT = Male Thread
JDF = High flow	
Quantity Filtercartridges	Adaptor
	DOE = Double open end
	C3 = 222 O-ring
	C7= Bayonet
Lenght	O-ring
25 = 10"	E = EPDM
50 = 20"	V = FPM
75 = 30"	
100 = 40"	
Material	Pressure
PP = Polypropylene	6 = 6 bar @ 40° C
HD-PE = Polyethylene	10 = 10 bar @ 40° C

Benefits

- In- and outlet position can be chosen
- Pressure up to 10 bar
- High chemical resistance
- Can be in environments with high concentrations of salt
- Optimal for use in desalination systems
- Low maintenance
- Easy and quick change of filter cartridges

For Clear Solutions

	JCF-3		JCF-5		
Dimensions in mm	Inlet / outlet DN 32/40/50	Inlet / outlet DN 65/80	Inlet / outlet DN 32/40/50	Inlet / outlet DN 65/80	Inlet / outlet DN 100
A	210	260	210	260	290
B	115	125	115	125	135
C	370	400	420	450	450
D	225	225	250	250	250
F	290	290	315	315	315
E 10" (6 bar/10 bar)	550/580	580/610	550/580	580/610	600/630
E 20" (6 bar/10 bar)	800/830	830/860	800/830	830/860	850/880
E 30" (6 bar/10 bar)	1050/1080	1080/1110	1050/1080	1080/1110	1100/1130
E 40" (6 bar/10 bar)	1320/1350	1350/1380	1320/1350	1350/1380	1370/1400

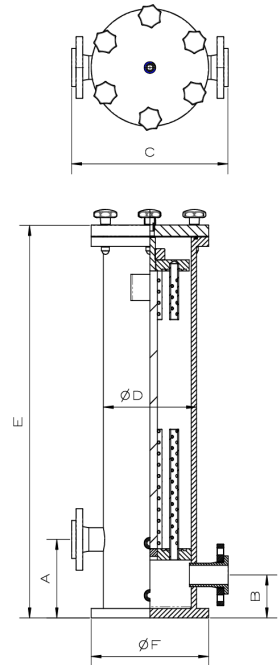

Pos	Name	Material
1	Handwheel	bakelite
2	Washer	Stainless steel
3	Vent 1/2" BSP	PP / HD-PE
4	Lid	PP / HD-PE
5	O-ring	EPDM / FMP
6	Nut	PP / HD-PE
7	Pressure plate	PP / HD-PE
8	Bolt set	Stainless steel
9	Name tag	PP / HD-PE
10	Housing	PP / HD-PE
11	Inlet	PP / HD-PE
12	Outlet	PP / HD-PE
13	Drain 1/2" BSP	PP / HD-PE

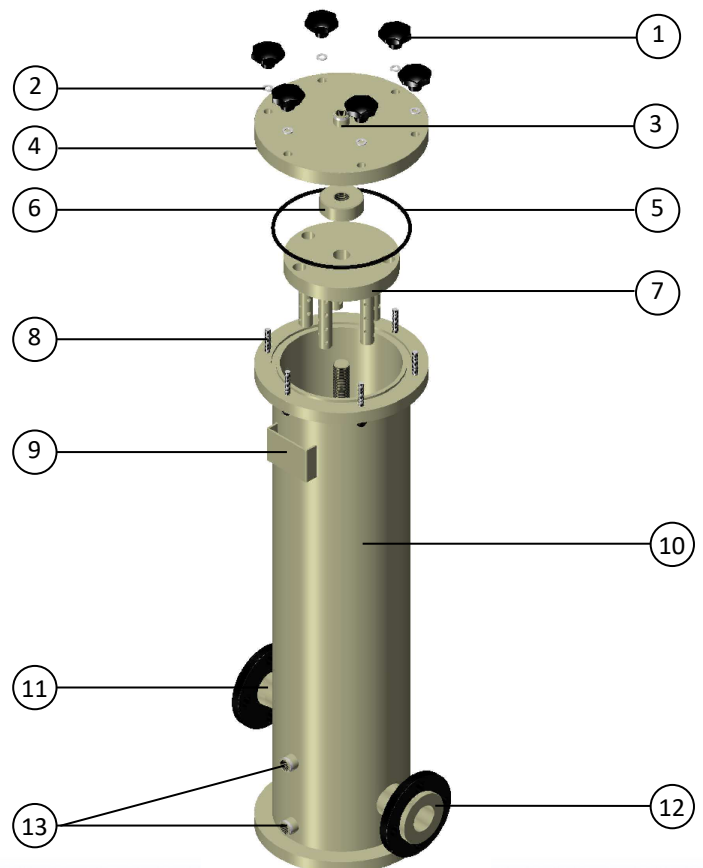

For Clear Solutions

Single housings

Our standard single filter housings are available in reinforced polypropylene and styrene acrylonitrile. The choice of the material is depending on the use of the filter housing. The clear bowl provides convenience of on-site and the blue bowl has excellent chemical and impact resistance. The standard housings can hold 10" and 20" cartridges with a diameter of 70 mm max. For large diameters we have big blue housings in our program, the maximum cartridge diameter is 115 mm. For special requirements we can make custom made single filter housings. Extra accessories are a key for easy opening and closing of the housing and a bracket for installation.

Applications

- Chemicals
- Laboratory
- Facilities
- Pre filtration RO
- Electronics
- Food & Beverage
- Cooling water



Specifications

Materials

Housing	Reinforced PP
	Styrene Acrylonitrile
Cap	Reinforced PP
O-ring	Buna-N

Dimensions

Outside diameter	92 mm
Length 10"	314 mm
Length 20"	571 mm

Other

Inlet/Outlet	½" NPTF
	¾" NPTF
Colour Housing	Blue (Polypropylene)
	Clear (Styrene Acryl.)
Flow rate 10"	0 to 1.1 m³/hr
Flow rate 20"	0 to 2.2 m³/hr
Max. temperature	60° C
Max. pressure	8,6 Bar

Specifications big blue housing

Dimensions

Outside diameter	148 mm
Length 10"	353 mm
Length 20"	604 mm

Other

Inlet/Outlet	1" NPTF / BSPF
	1½" NPTF / BSPF
Flow rate 10"	0 to 4,5 m³/hr
Flow rate 20"	0 to 9 m³/hr
Max. temperature	60° C
Max. pressure	7 Bar

For Clear Solutions